

Dr. Babasaheb Ambedkar Technological University,

P.O. LONERE - 402 103, Tal. Mangaon, Dist. Raigad

Our Ref No. : DBATU/Store/Civil/Drawing Table & Stool/2018/1462 Date: 04.07.2018

Quotation for : Drawing Table Adjustable type & Stool

Due On: 23.07.2018

Date of Opening: 24.07.2018

Time: 03.00 pm

=====

To,

As per attached list

Sub: QUOTATION FOR Drawing Table Adjustable type & Stool

Dear Sir,

Your quotation for the items listed overleaf, may please be submitted to the under signed, so as to reach this Office not later than 23.07.2018

While submitting your quotation, the following procedure may please be observed and other points borne in mind.

01. The maker's name must be specified.
02. The "Terms and Conditions" for supply and delivery of stores, should be clearly indicated in the quotation, stating whether rates are, inclusive of all taxes, Packing and forwarding charges Freight charges etc. or not, However rates offered as including all taxes will be more welcome.
03. If packing and forwarding charges are to be charged separately, it should be so clearly stated in your quotation.
04. Please mention clearly whether consignment would be Ex-Godown, Ex-Shop, of F.O.R. dispatching stations. Preferably terms offered as "Delivery of consignment of stores, on F.O.R."
05. Envelope should be clearly marked with our reference No and date of this quotation. It should also be superscripted as per the format given above.
06. The quotation would be opened as per date and timing given above, if desired by you, you may depute an authorized representative with a letter of authority to be present at the time of opening of the quotation at this Office on the aforesaid day, date & time.
07. Your quotation must be valid for a minimum 30 (Thirty) working days from the date of it's opening.
08. Quotation received after the date of opening may not be taken into consideration.
09. Items tendered should confirm to the specification shown in the attached list when and where, full or no specifications are indicated against items in the list. Kindly furnish your full specification in accordance with accepted standards against each item tendered. Where reference to catalogue is made, the relevant catalogues/ Pamphlets/ Literature should accompany the quotation.
10. Your quotation should be for all new items and not for second hand.
11. Please state whether items will be available Ex-Stock. If not the minimum period for delivery, or for supplying the items or stores.

12. It should be clearly stated whether **GST** Insurance Freight or packing and forwarding charges, or any other taxes and duties etc. leviable.
13. It would be appreciated if illustrated catalogues/Literature etc is furnished with the quotation.
14. Expression to as "Complete with standard Equipment" complete with standard accessories "Equipment to" As good as should be avoided. If at all their use is unavoidable then it should be very specifically indicated as to what exactly they mean and what exactly would be supplied under them. Any ambiguity or vagueness should be avoided.
15. For convenience, kindly adopt while quoting the same serial Nos. as given in the list detailed below.

Thanking You.

Yours faithfully,

-Sd-

(Dr. Sunil S. Bhamare)

Registrar

Dr. Babasaheb Ambedkar Technological University,

List of Items

Sr. No	Description / Specification	Make	Appox. Qty. Req	Rate per Unit	Remark
01	Drawing Table Adjustable type (Specifications as per attached list.)	-	25	-	-
02	Drawing Stool (Specifications as per attached list.)	-	25	-	-

Drawing Table Adjustable type

Drawing stands with tilt adjustable as well angular arrangement. Imperial suitable for 23"X32" drawing board. Steel tray for storage of drawing material. Prime Quality CR pipes 1" with 16 gauge, mechanized manufacturing with epoxy powder coating.

Specifications:-

Materials-

- 1) 16 swg CRCA pipe with red oxide & paint coating on Frame.
- 2) Drawing board (standard Alekhan / Similar quality drawing board)
- 3) Nylon bush
- 4) Steel Tray

Drawing-

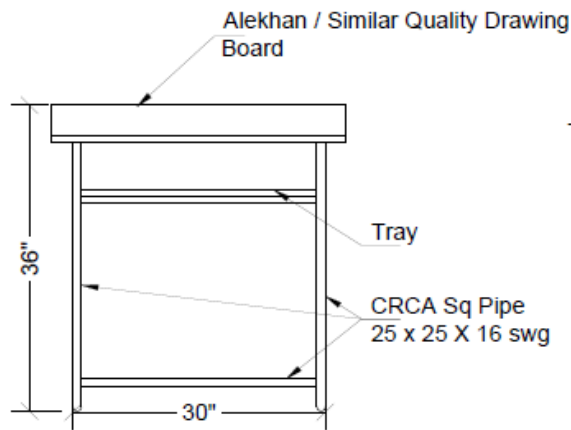

Sectional Elevation

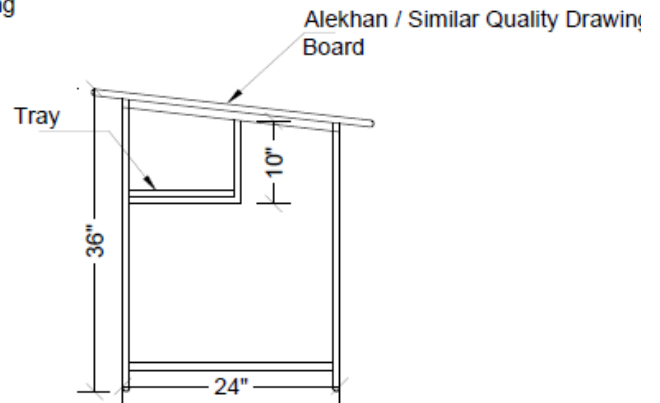

Sectional Elevation

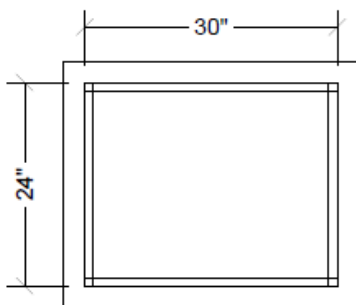

Plan
Drawing Table with Tray

Drawing stool with sun mica top

Size - top size 12"X12" X27"

Drawing stool with sunmica top made of CRCA 16 swg 25mmX25mm pipe frame and Plywood 18mm thick (waterproof marine ply) With Sunmica 1mm thick (wooden textured mat finish). Legs of the frame should be provided with nylon bush and the entire frame be painted with one coat of primer and one coat of spray painting. Welded joints should have enough strength against failure load.

Material-

- 1) CRCA Square pipe 25X25mmX16 g
- 2) Plywood 18 mm thick (water proof marine ply)
- 3) Sun mica 1 mm (wooden texture mat finish)
- 4) Nylon Bush

Drawing –

